

**VOLTAGE RANGE: 50 - 1000V**  
**CURRENT: 1.0A**

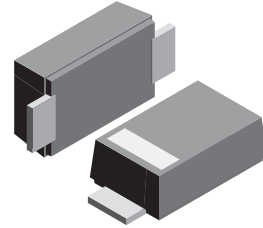

### Features

- Glass passivated device
- Ideal for surface mounted applications
- Low reverse leakage
- Metallurgically bonded construction
- High temperature soldering guaranteed:
- 250°C/10 seconds, 0.375" (9.5mm) lead length, 5 lbs. (2.3kg) tension

### Mechanical Data

- Case: JEDEC SOD-123FL molded plastic body over passivated junction
- Terminals : Plated axial leads,
- solderable per MIL-STD-750, Method 2026
- Polarity : Color band denotes cathode end
- Mounting Position : Any
- Weight: 0.0007 ounce, 0.02 grams

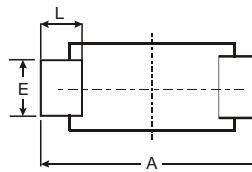
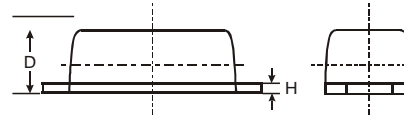
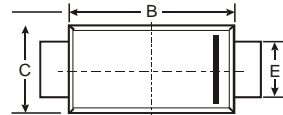

SOD-123FL			
Dim	Min	Max	Typ
A	3.50	3.80	3.65
B	2.60	2.90	2.75
C	1.70	1.90	1.80
D	0.09	1.10	1.00
E	0.08	1.10	0.095
H	0.12	0.20	0.16
L	0.07	0.09	0.08
All Dimensions in mm			

### Maximum Ratings and Electrical Characteristics T<sub>A</sub> = 25°C unless otherwise specified

Single phase, half wave, 60Hz, resistive or inductive load. For capacitive load, derate current by 20%.

Characteristic	Symbol	FSM11PL	FSM12PL	FSM13PL	FSM14PL	FSM15PL	FSM16PL	FSM17PL	Unit
Maximum repetitive peak reverse voltage	V <sub>RRM</sub>	50	100	200	400	600	800	1000	V
Maximum RMS voltage	V <sub>RMS</sub>	35	70	140	280	420	560	700	V
Maximum DC blocking voltage	V <sub>DC</sub>	50	100	200	400	600	800	1000	V
Maximum average forward rectified current at T <sub>A</sub> =65°C (NOTE 1)	I <sub>(AV)</sub>	1.0							A
Peak forward surge current 8.3ms single half sine-wave superimposed on rated load (JEDEC Method) T <sub>L</sub> =25°C	I <sub>FSM</sub>	30.0							A
Maximum instantaneous forward voltage at 1.0A	V <sub>F</sub>	1.3							V
Maximum DC reverse current T <sub>A</sub> =25°C at rated DC blocking voltage T <sub>A</sub> =100°C	I <sub>R</sub>	5.0 100.0							μA
Maximum reverse recovery time (NOTE 2)	t <sub>rr</sub>	150			250		500		ns
Typical junction capacitance (NOTE 3)	C <sub>J</sub>	15							pF
Typical thermal resistance (NOTE 4)	R <sub>θJA</sub>	180							K/W
Operating junction and storage temperature range	T <sub>J</sub> , T <sub>STG</sub>	-50 to +150							°C

- Note:**
1. Averaged over any 20ms period.
  2. Measured with I<sub>F</sub>=0.5A, I<sub>R</sub>=1A, I<sub>rr</sub>=0.25A.
  3. Measured at 1MHz and applied reverse voltage of 4.0V D.C.
  4. Thermal resistance junction to ambient, 6.0 mm<sup>2</sup> copper pads to each terminal.

## RATINGS AND CHARACTERISTIC CURVES FSM11PL THRU FSM17PL

AVERAGE FORWARD RECTIFIED CURRENT,  
AMPERES

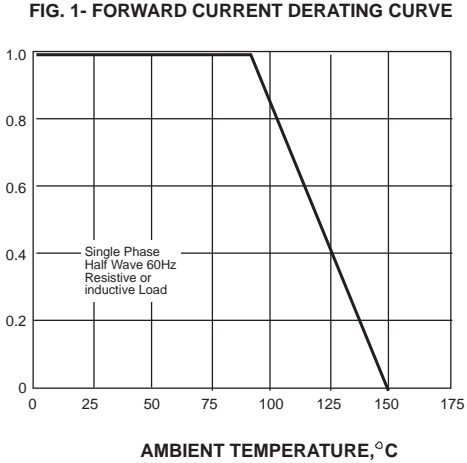

**FIG. 2-MAXIMUM NON-REPETITIVE PEAK FORWARD SURGE CURRENT**

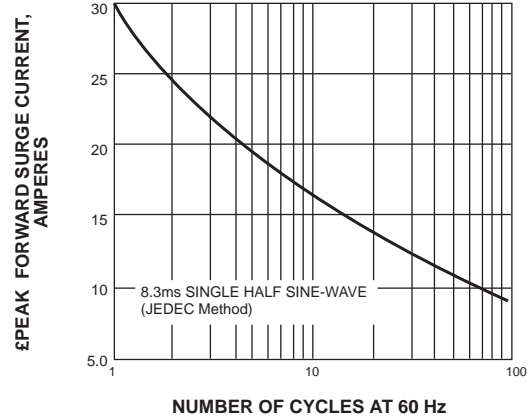

**FIG. 3-TYPICAL INSTANTANEOUS FORWARD CHARACTERISTICS**

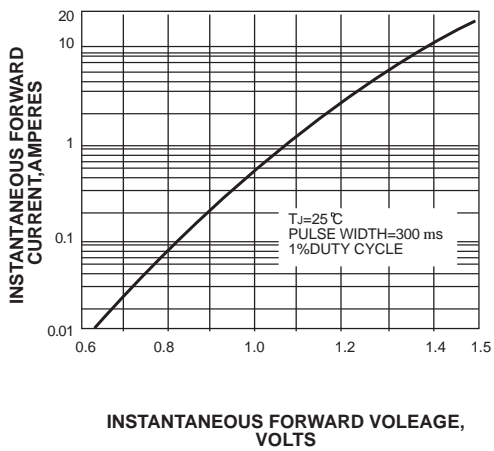

**FIG. 4-TYPICAL REVERSE CHARACTERISTICS**

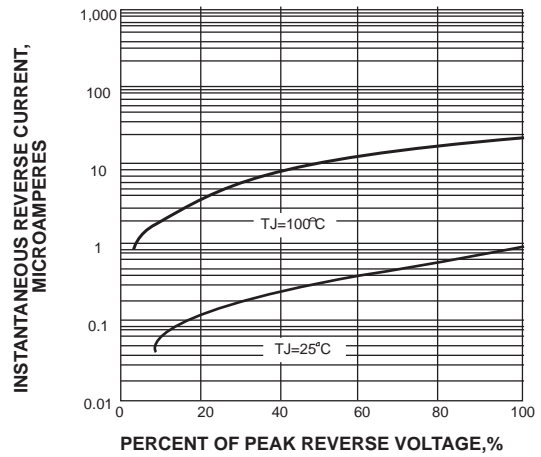

**FIG. 5-TYPICAL JUNCTION CAPACITANCE**

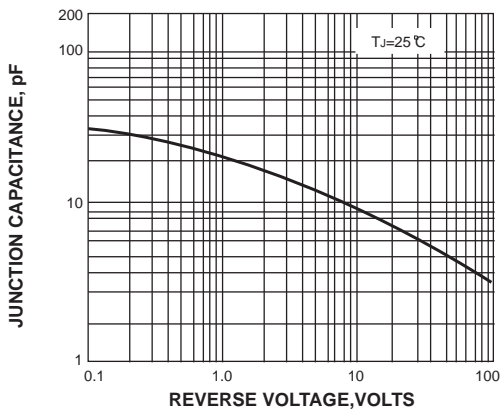

**FIG. 6-TYPICAL TRANSIENT THERMAL IMPEDANCE**

